

Scanning distance
 100...800 mm
 Photoelectric proximity switches

- Laser LED, red light
- Adjustable background suppression

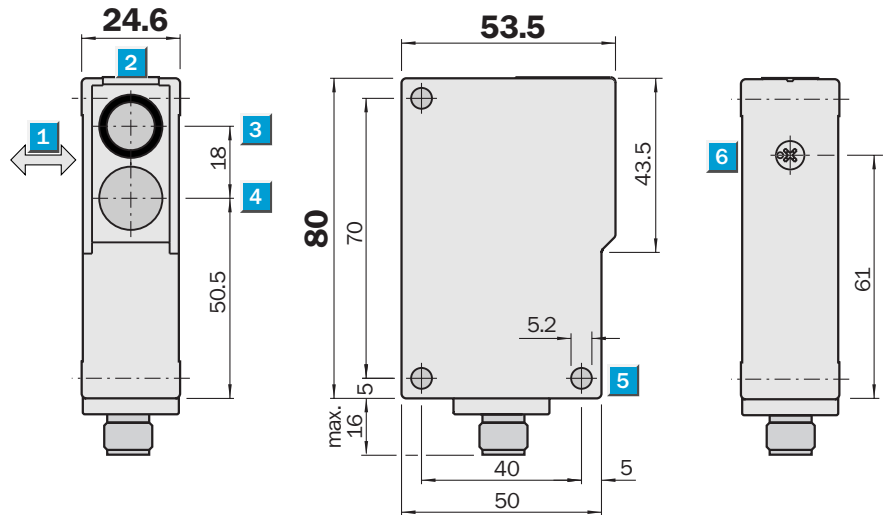

Dimensional drawing



Adjustments possible

WT 27L-2F 430

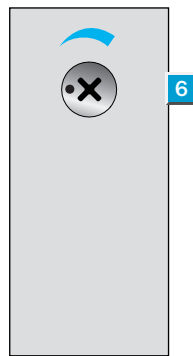

- 1 Standard direction of the material being scanned
- 2 LED signal strength indicator
- 3 Optical axis, sender
- 4 Optical axis, receiver
- 5 Mounting hole \varnothing 5.2 mm
- 6 Sensitivity adjustment

Connection type

WT 27L-2F 430

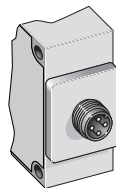

4-pin, M12

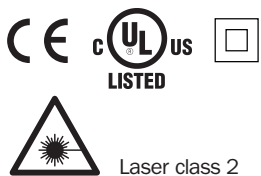
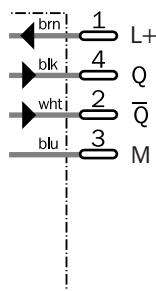

See chapter Accessories

Cables and connectors

Mounting systems

Technical data		WT 27L-2	F 430											
Scanning distance	100...800 mm, adjustable													
Light source¹⁾, light type	LED laser, red light													
Light spot diameter	Approx. 2 mm at 400 mm													
Supply voltage V_S	10...30 V DC ²⁾													
Residual ripple ³⁾	$\leq 5 V_{PP}$													
Current consumption ⁴⁾	$\leq 35 \text{ mA}$													
Switching outputs	PNP, Q and \bar{Q}													
Output current I_A max.	100 mA													
Response time ⁵⁾	500 μs													
Max. switching frequency ⁶⁾	1000/s													
Connection type	Plug													
VDE protection class⁷⁾	<input type="checkbox"/>													
Laser class⁸⁾	2 (IEC 825/VDE 0837)													
Circuit protection⁹⁾	A, B, C													
Enclosure rating	IP 67													
Ambient temperature T_A	Operation $-10 \text{ }^\circ\text{C} \dots +45 \text{ }^\circ\text{C}$ Storage $-10 \text{ }^\circ\text{C} \dots +75 \text{ }^\circ\text{C}$													
Weight	Approx. 100 g													
Housing material	ABS													

1) Average service life 50,000 h at $T_A = +25 \text{ }^\circ\text{C}$
 2) Limit values
 3) May not exceed or fall short of V_S tolerances

4) Without load
 5) Signal flight time with ohmic load
 6) With light/dark ratio 1:1
 7) Reference voltage 50 V DC

8) Low power. Eyes normally protected by averting reaction and eyelid closing reflex.

9) A = V_S connections reverse-polarity protected
 B = Output Q and \bar{Q} short-circuit protected
 C = Interference pulse suppression

Scanning distance

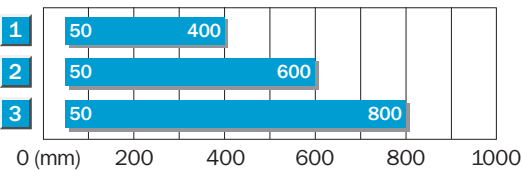

- 1 Scanning distance on black, 6 % remission
- 2 Scanning distance on grey, 18 % remission
- 3 Scanning distance on white, 90 % remission

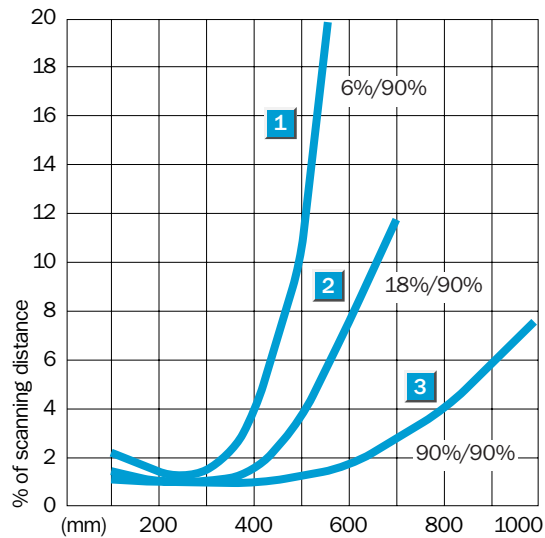

Order information

Type	Order no.
WT 27L-2F 430	1 016 019