

Zubehör Magnete

- Eignung zum Einsatz mit magnetischen Näherungssensoren



Maßbilder

MAG-1003-S (M1.0)

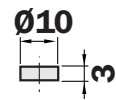

MAG-0625-A (M2.0)

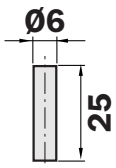

MAG-2006-B (M3.0)

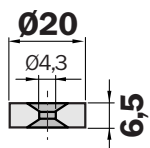

MAG-3010-B (M4.0)

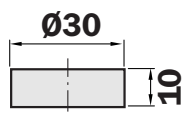

MAG-3015-B (M5.0)

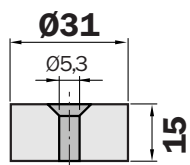

MAG-3515-B (M5.1)

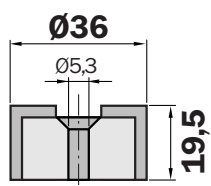

Technische Daten		MAG-	1003-S (M1.0)	0625-A (M2.0)	2006-B (M3.0)	3010-B (M4.0)	3015-B (M5.0)	3515-B (M5.1)				
<b>Magnetwerkstoff</b>	Samarium Cobalt SM2CO17		■									
	AlNiCo			■								
	Bariumferrit				■	■	■	■				
<b>Ummantelungswerkstoff</b>	Polyamid PA6.6							■				
<b>Umgebungstemperatur</b>	-100 °C ... +450 °C			■								
	-50 °C ... +180 °C		■									
	-25 °C ... +130 °C				■	■	■					
	-25 °C ... +75 °C							■				

Bestell-Information	
Typ	Bestell-Nr.
MAG-1003-S (M1.0)	7 901 782
MAG-0625-A (M2.0)	7 901 783
MAG-2006-B (M3.0)	7 901 784
MAG-3010-B (M4.0)	7 901 785
MAG-3015-B (M5.0)	7 901 786
MAG-3515-B (M5.1)	7 902 086