

Delivery address: Mackenrodtstraße 14,  
36039 Fulda, Germany  
Postal address: 36035 Fulda, Germany  
Phone: +49 661 60 03-0  
Fax: +49 661 60 03-6 07  
E-mail: mail@jumo.net  
Internet: www.jumo.de

JUMO House  
Temple Bank, Riverway  
Harlow, Essex CM20 2TT, UK  
Phone: +44 12 79 63 55 33  
Fax: +44 12 79 63 52 62  
E-mail: sales@jumo.co.uk

885 Fox Chase, Suite 103  
Coatesville PA 19320, USA  
Phone: 610-380-8002  
1-800-554-JUMO  
Fax: 610-380-8009  
E-mail: info@JumoUSA.com  
Internet: www.JumoUSA.com



# Pressure separator with ISS connection or SMS connection or RJT connection and slotted ring nut Type 409778

## Diaphragm pressure separator with ISS connection

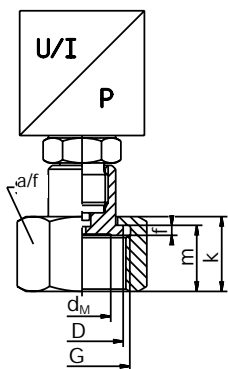

## Technical data

Process connection	Nominal pressure bar	Recommended min. pressure range bar	Temperature coefficient mbar/10°C	Weight (without meas. device) kg	Dimensions [mm]						
					a/f	d <sub>M</sub>	D	thread G	f	m	k
DN1"	PN40	above 6	+30	0.35	47	24	33	1½ x 1/8"	4	26.5	30
DN1½"		above 0.4	+12	0.59	62	34	47	2 x 1/8"			
DN2"		above 0.1	+3	1.00	77	45	60	2½ x 1/8"			

Diaphragm pressure separator with SMS connection

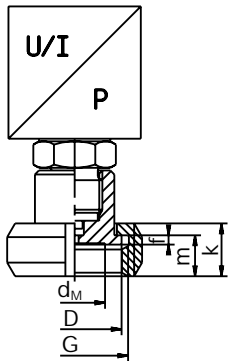

Technical data

Process connection	Nominal pressure bar	Recommended min. pressure range bar	Temperature coefficient mbar/10°C	Weight (without meas. device) kg	Dimensions [mm]					
					d <sub>M</sub>	D	thread G	f	m	k
DN1"	PN40	above 6	+30	0.22	24	35.5	Rd40 x 1/6"	3.5	15.5	20
DN1 1/2"		above 0.4	+12	0.60	34	55	Rd60 x 1/6"	4	21	25
DN2"		above 0.1	+3	1.00	46	65	Rd70 x 1/6"			26

Diaphragm pressure separator with RJT connection

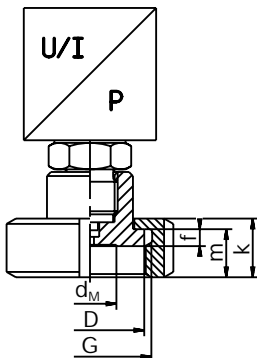

Technical data

Process connection	Nominal pressure bar	Recommended min. pressure range bar	Temperature coefficient mbar/10°C	Weight (without meas. device) kg	Dimensions [mm]					
					d <sub>M</sub>	D	thread G	f	m	k
DN1"	PN40	above 6	+30	0.40	20	41	1 13/16 x 1/8"	6.4	18	22
DN1 1/2"		above 0.4	+12	0.75	28	54	2 5/16 x 1/8"			22
DN2"		above 0.1	+6	1.00	38	67	2 7/8 x 1/6"			

## Order details

	<b>(1) Basic type</b>
409778	pressure separator with ISS connection or with SMS connection or with RJT connection and slotted ring nut
	<b>(2) Basic type extension</b>
00	none
	<b>(3) Process connection</b>
587	ISS DN1"
588	ISS DN1 <sup>1</sup> / <sub>2</sub> "
589	ISS DN2"
584	SMS DN1"
585	SMS DN1 <sup>1</sup> / <sub>2</sub> "
586	SMS DN2"
577	RJT DN1"
578	RJT DN1 <sup>1</sup> / <sub>2</sub> "
579	RJT DN2"
	<b>(4) Nominal pressure in bar</b>
040	PN40
	<b>(5) Material</b>
20	st. steel
99	special material <sup>1</sup>
	<b>(6) Filling liquid</b>
1	silicone oil
2	inert liquid
3	vegetable oil
	<b>(7) Capillary</b>
0000	no capillary
0001	with cooling device
1000	1.0 m capillary
1500	1.5 m capillary
2000	2.0 m capillary
3000	3.0 m capillary
5000	5.0 m capillary

	(1)	(2)	(3)	(4)	(5)	(6)	(7)
Order code	409778	/ 00	-	040	-	-	-
Order example	409778	/ 00	- 588	040	- 20	- 3	- 1500

<sup>1</sup> please specify in plain text when ordering